

MOBILE SOCIAL DISTANCING SHIELDS

Item # MBSLD, MBSLDO

2 PEOPLE
NEEDED FOR
ASSEMBLY

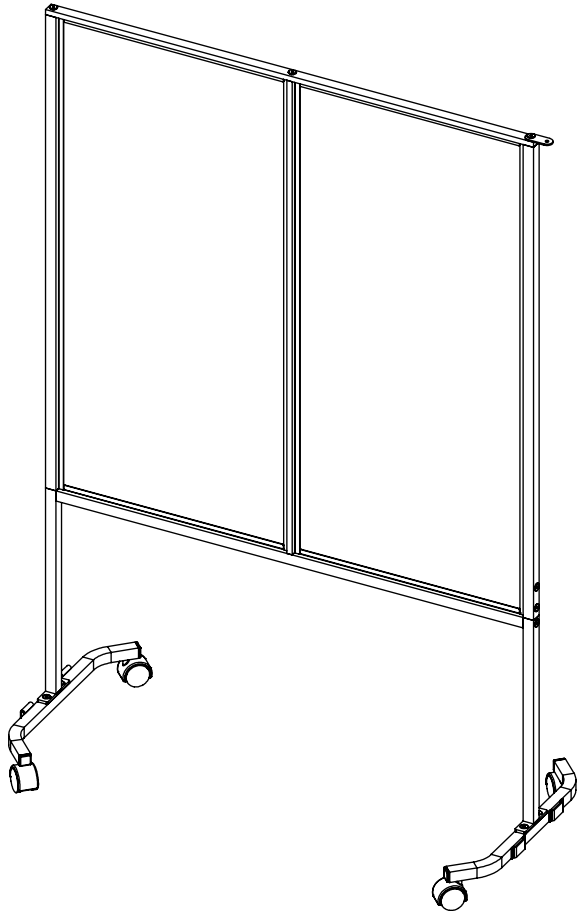

INCLUDED HARDWARE

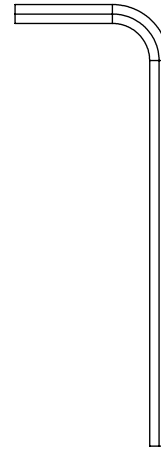

2X
ALLEN KEY



1X
CASTER WRENCH

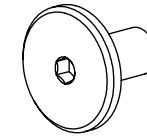

4X
1/4-20 x 0.5" LONG
LOW PROFILE SOCKET
HEAD CAP SCREW

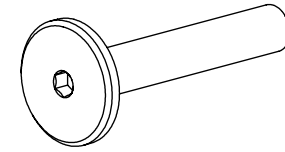

6X
1/4-20 x 1.5" LONG
LOW PROFILE SOCKET
HEAD CAP SCREW

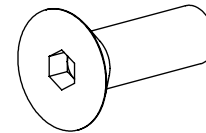

4X
5/16-18 x 1" LONG
CSK SOCKET HEAD
CAP SCREW



3X
1/4 SPRING LOCK
WASHER

1

USE INCLUDED CASTER WRENCH TO ASSEMBLE THE SIDE-BASES WITH CASTERS.

- A. ASSEMBLE THE BASE WITH BELT LOOP WITH CASTERS.
- B. ASSEMBLE THE BASE WITH HOOK WITH CASTERS.

NOTE: PUT THE NON-LOCKING/ LOCKING CASTERS AS SHOWN.

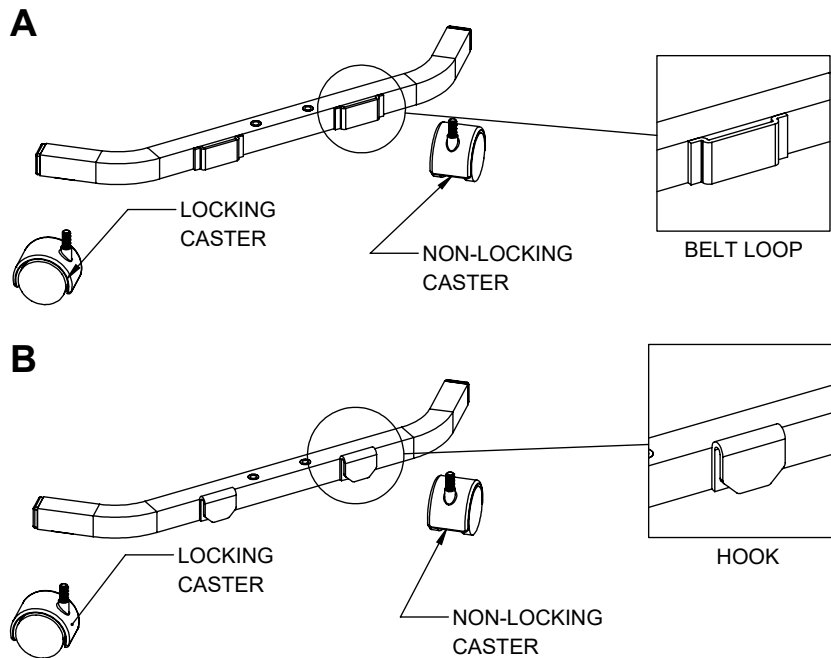

2

- A. ASSEMBLE THE SIDE-BOTTOM WITH BASE.
- B. ASSEMBLE THE SIDE-BOTTOM WITH SIDE-TOP.

NOTE: WHEN ASSEMBLING BASE TO SIDE-BOTTOM, THE BENT LEGS SHOULD FACE THE SAME DIRECTION AS THE U CHANNEL.

REPEAT FOR SECOND SET OF SIDE PIECES.

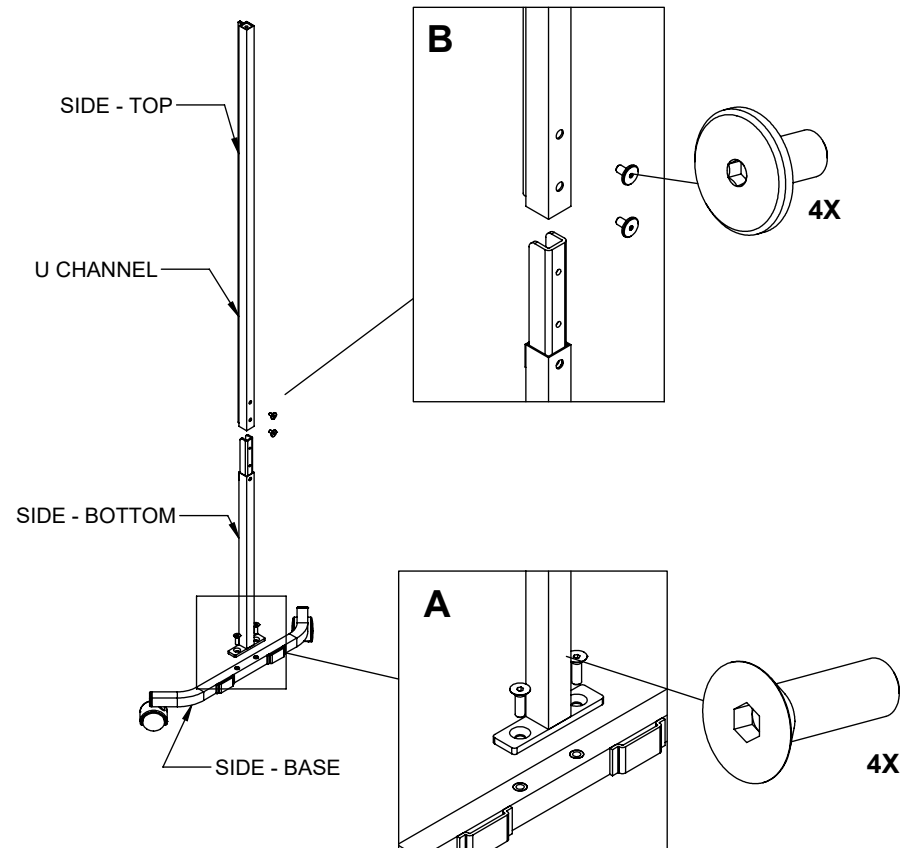

3

ASSEMBLE (2) SIDES WITH
BOTTOM CROSSBAR. MAKE SURE
U CHANNEL IS FACING UP.

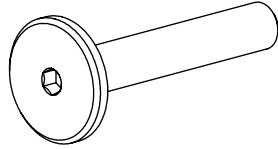

2X

1/4-20 x 1.5" LONG
LOW PROFILE SOCKET
HEAD CAP SCREW

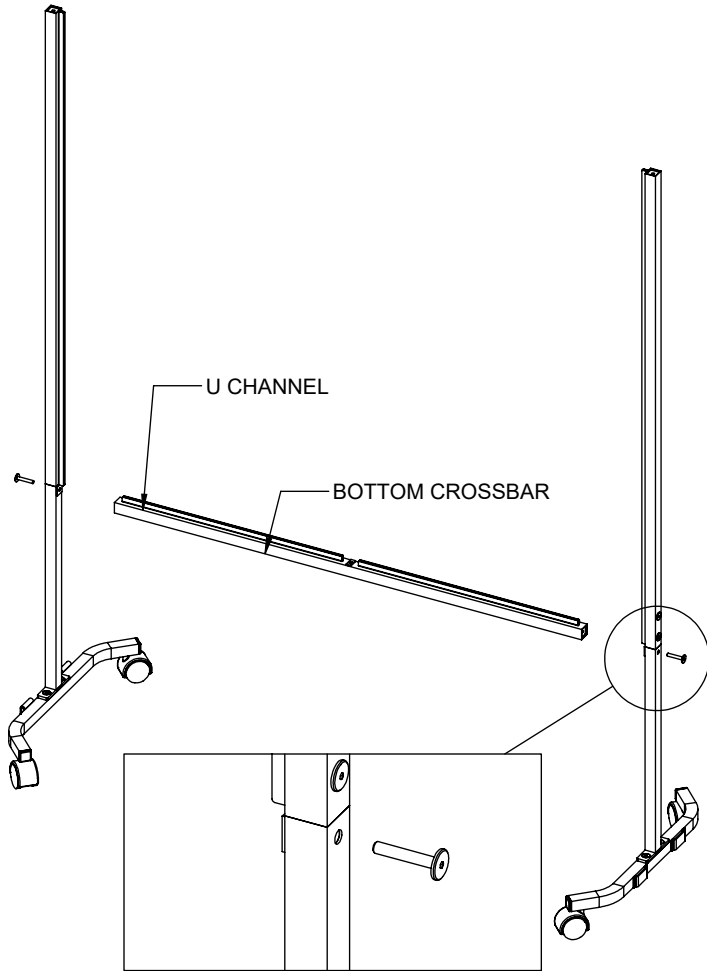

4

ASSEMBLE MIDDLE UPRIGHT.

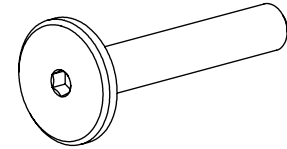

1X

1/4-20 x 1.5" LONG
LOW PROFILE SOCKET
HEAD CAP SCREW

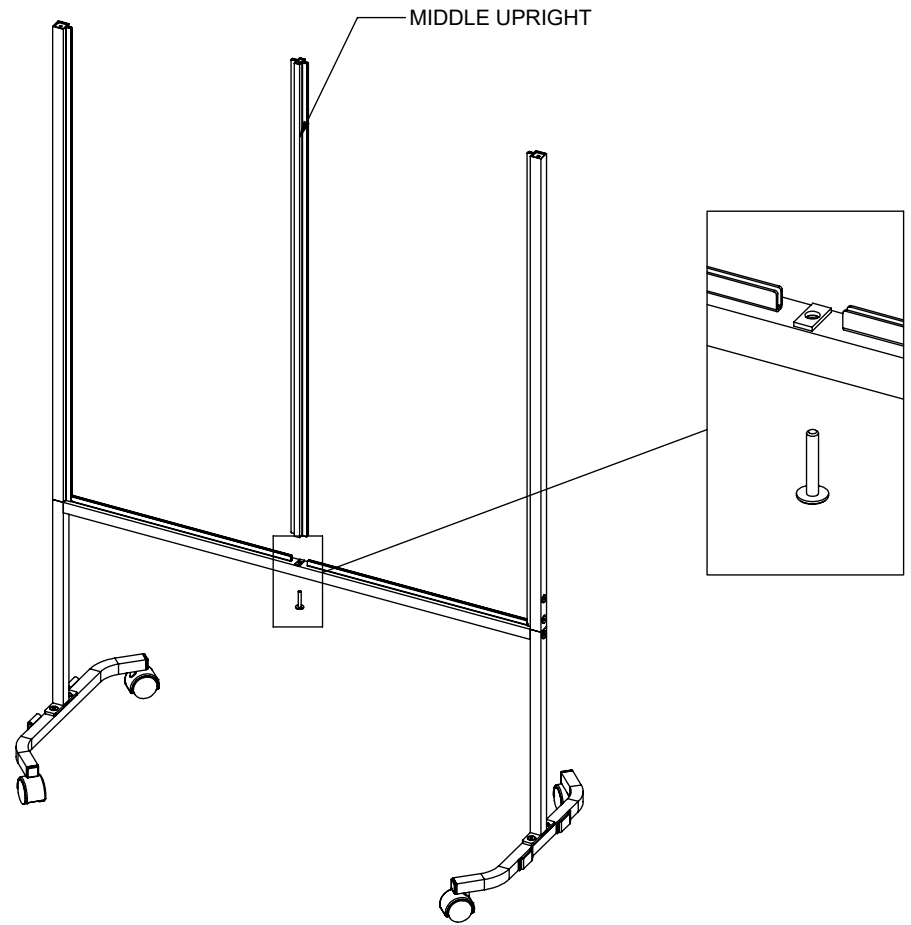

5

TIP UNIT ON ITS SIDE.
MAKE SURE THE SIDE-BASE WITH HOOK IS FACING UPWARDS.

CAREFULLY SLIDE BOTTOM PANEL INTO RACK.
TAKE CARE NOT TO BEND THE ACRYLIC WHEN SLIDING IN ACRYLIC PANEL.

SIDE BASE WITH HOOK IS ON TOP.

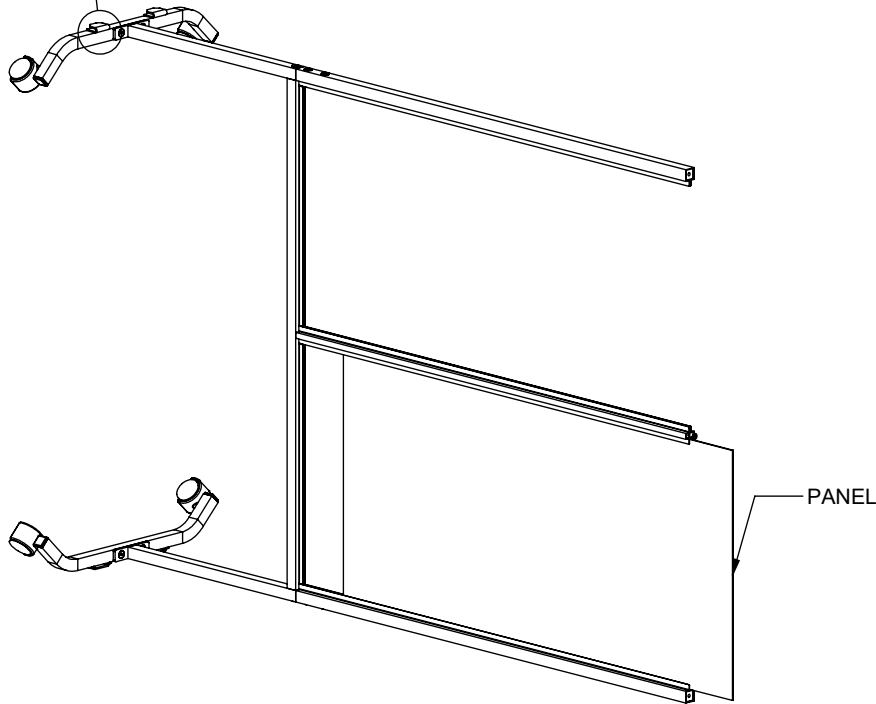
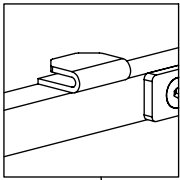

6

CAREFULLY SLIDE TOP PANEL INTO RACK.
TAKE CARE NOT TO BEND THE ACRYLIC WHEN SLIDING IN ACRYLIC PANEL.

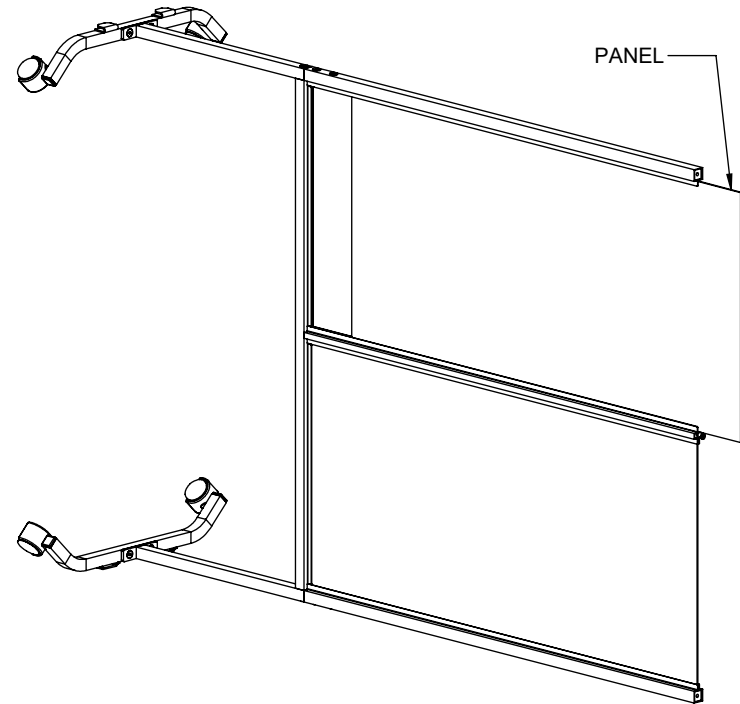

7

ASSEMBLE TOP CROSSBAR.
HAND TIGHTEN FROM TOP TO BOTTOM.
THEN GO BACK AND FULLY TIGHTEN WITH ALLEN KEYS.

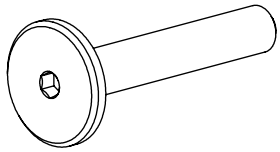

3X
1/4-20 x 1.5" LONG
LOW PROFILE SOCKET
HEAD CAP SCREW

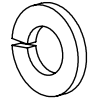

3X
1/4 SPRING LOCK
WASHER

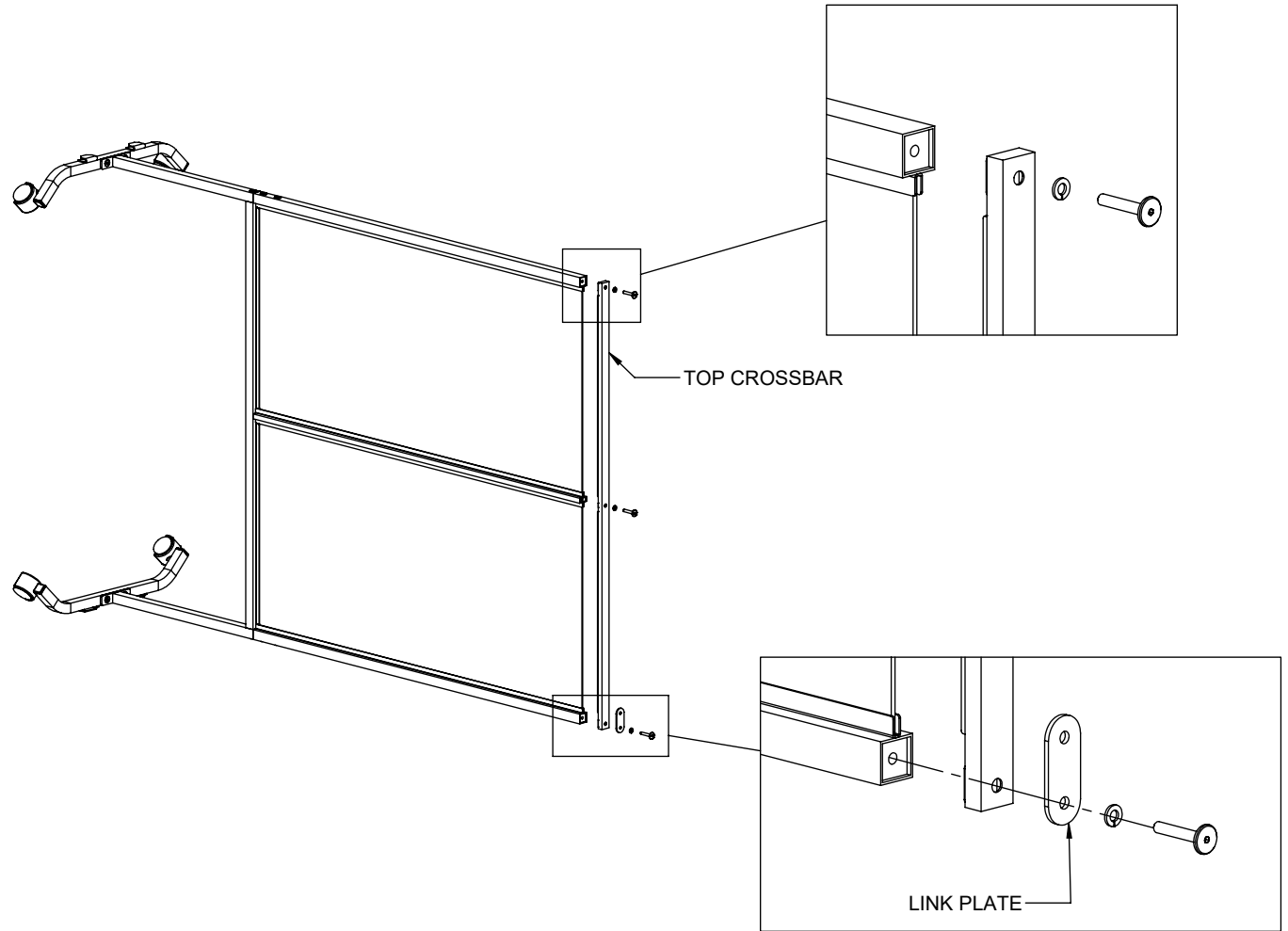

FOR PUTTING (2) ROLLING RACKS TOGETHER

1

PUT TWO UNITS SIDE BY SIDE.

MAKE SURE THE BASE WITH BELT LOOP AND BASE WITH HOOK ARE PLACED END TO END.

HOOK THE TWO BASES TOGETHER. LIFT THE BASE WITH HOOK AND DROP IT INSIDE THE BELT LOOP.

2

UNSCREW THE TOP SCREWS FROM THE JOINING UNIT. SWING LINK PLATE AND SCREW IN TO SECURE THE TWO UNITS ON TOP.

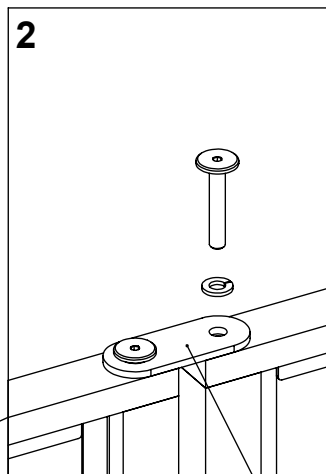
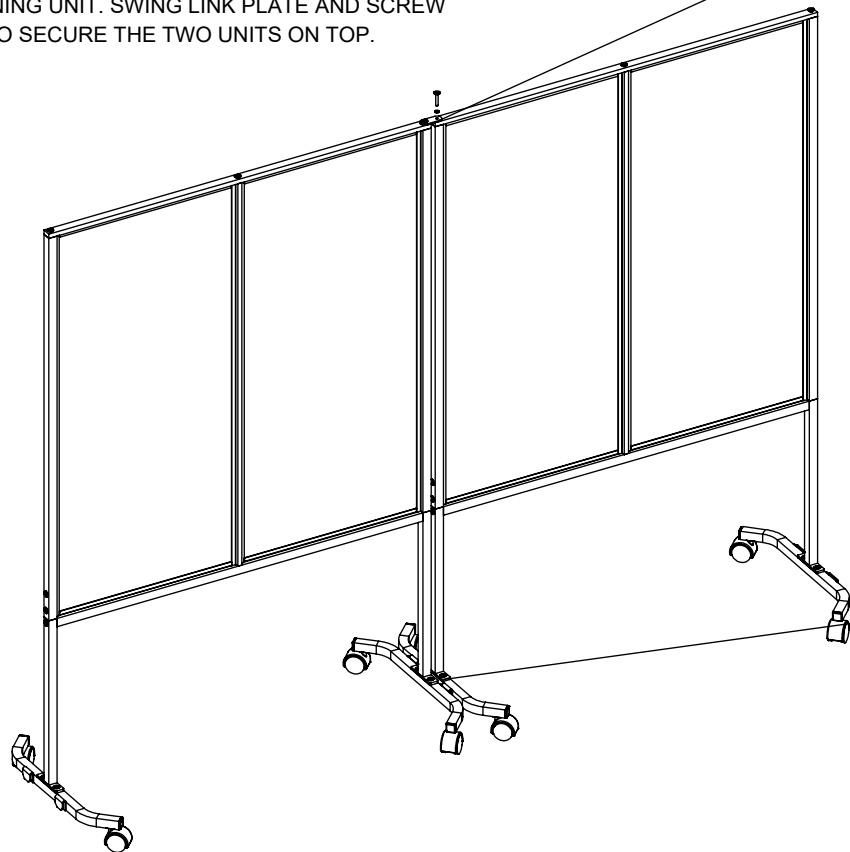

LINK PLATE

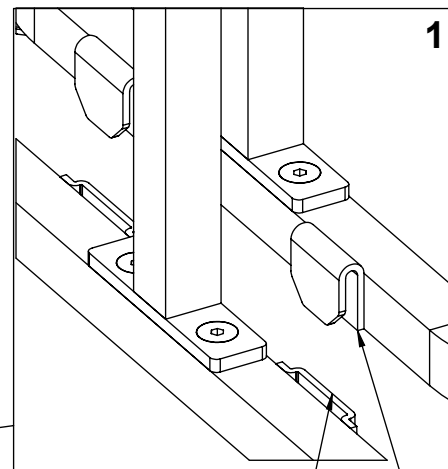
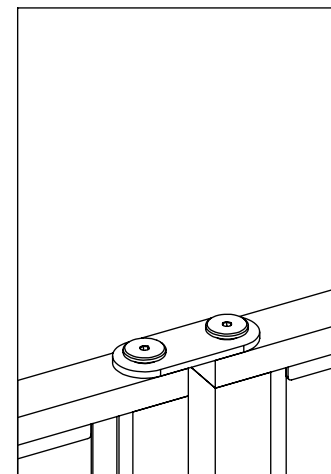

BASE WITH BELT LOOP

BASE WITH HOOK

