

ADJUSTABLE FLOOR STANDING BANNER DISPLAY

Item # DBD96(F)

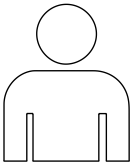
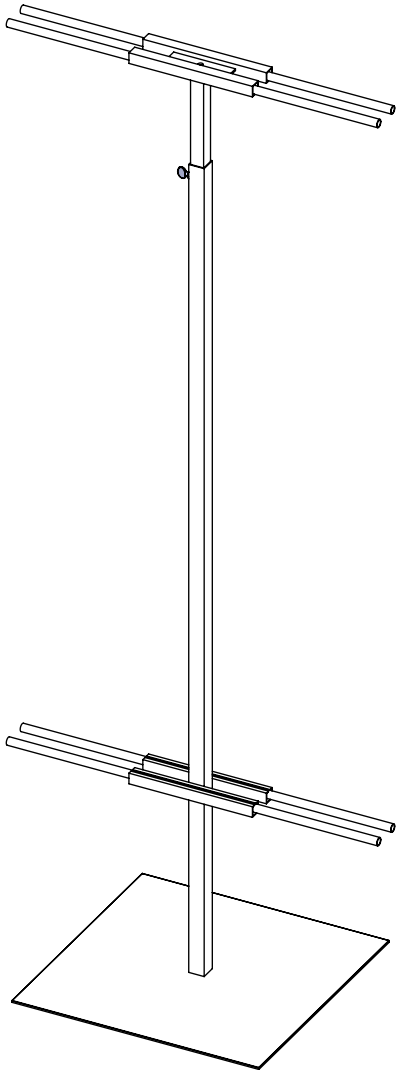

**2 PEOPLE
REQUIRED FOR
ASSEMBLY**

INCLUDED HARDWARE

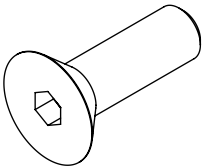

1X
3/8"-16 X 1 1/2" LONG CSK SCREW

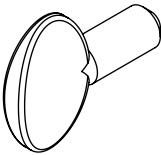

1X
1/4"-20 CUP POINT THUMB SCREW

TOOLS REQUIRED

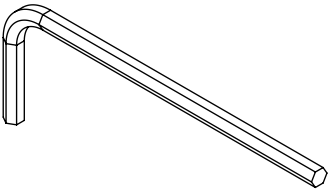

ALLEN KEY

1

PLACE ONE SIDE OF THE BASE ON THE FLOOR AND HOLD IT WHILE ANOTHER PERSON POSITIONS THE OUTER UPRIGHT. THEN FASTEN USING (1) 3/8"-16 X 1 1/2" LONG CSK SCREW, AND THE ALLEN KEY.

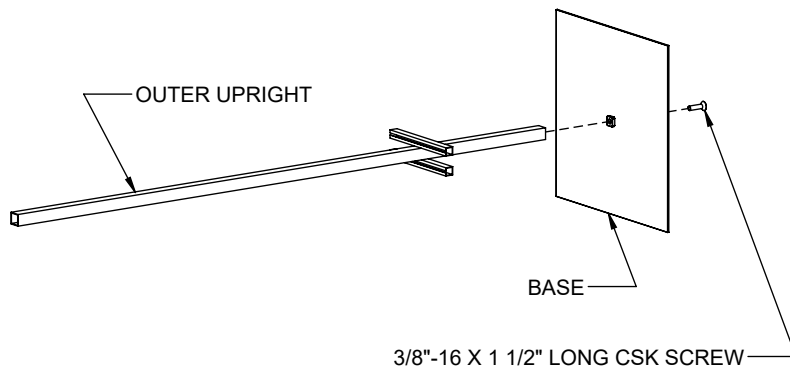

2

PLACE THE BASE ON THE FLOOR AND LOWER THE INNER UPRIGHT INTO THE OUTER UPRIGHT.

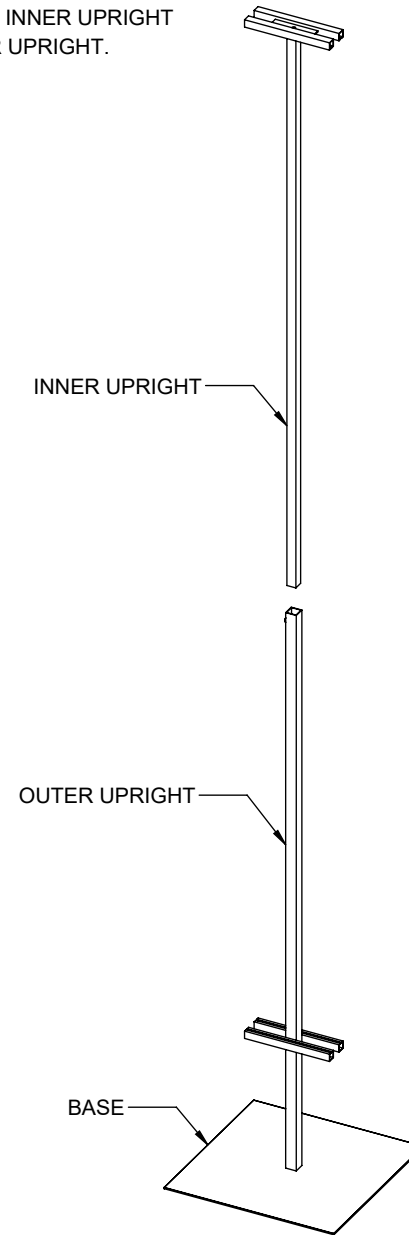

3

HOLD THE BANNER UP TO THE UNIT, AND LINE UP THE UPPER BANNER POCKET WITH THE UPPER ROD BRACKET, THEN HAVE ANOTHER PERSON INSERT THE BANNER ROD. REPEAT THIS PROCESS WITH THE BOTTOM OF THE BANNER.

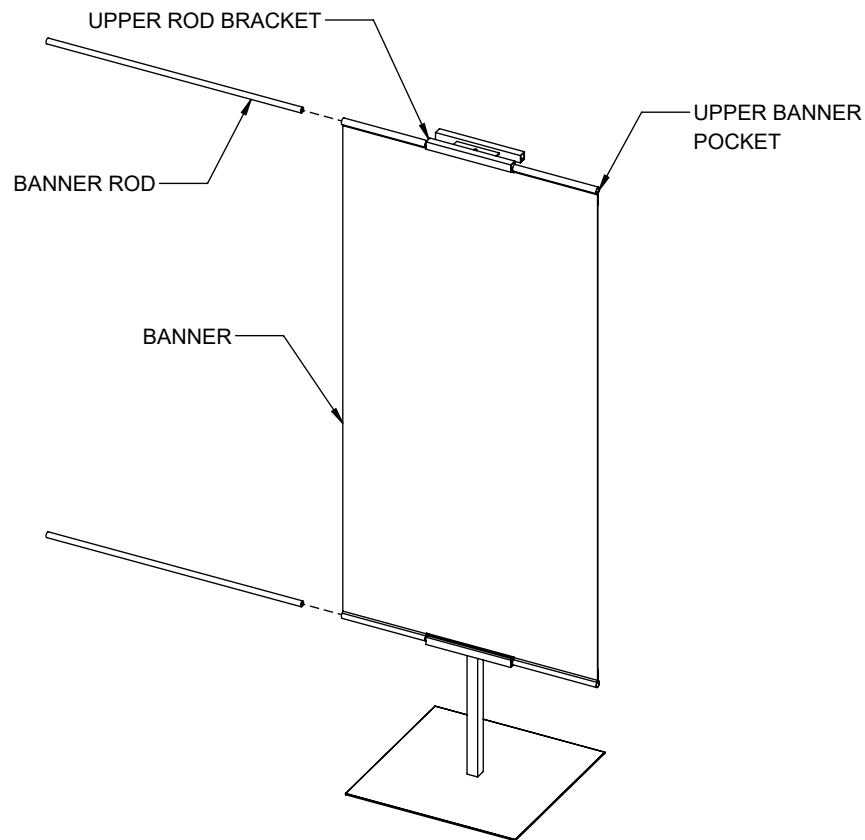

4

REPEAT STEP 3 ON THE OTHER SIDE IF YOU ARE INSTALLING A SECOND BANNER. NEXT PUSH THE UPPER ROD BRACKET UPWARDS UNTIL THE BANNER(S) IS TAUGHT, THEN HAVE ANOTHER PERSON THREAD IN AND TIGHTEN THE THUMB SCREW.

