

# Deluxe Cash Wrap Retail Counter Drawer Unit with Retail Shelving Kit

ITEM # DDCWDRST(F)

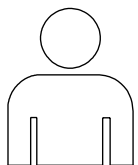

**2 PEOPLE  
REQUIRED  
FOR  
ASSEMBLY**

## INCLUDED HARDWARE

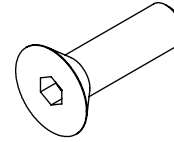

**12X**  
1/4\"-20 x 0.875\" LONG  
CSK SOCKET HEAD SCREW

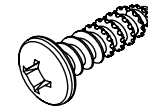

**7X**  
#10 x 0.75\" LONG PAN HEAD  
WOOD SCREW

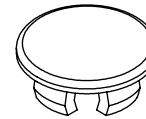

**7X**  
NYLON SNAP-IN PANEL PLUG

## TOOLS REQUIRED

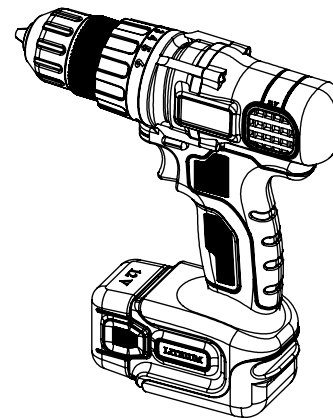

POWER DRILL  
(NOT INCLUDED)

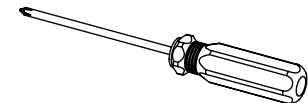

PHILLIPS HEAD SCREWDRIVER  
(NOT INCLUDED)



ALLEN KEY

**1**

PLACE THE RIGHT SIDE FRAME ON IT'S SIDE WITH THE NUTPLATES FACING UP, AND ATTACH THE UPPER/ LOWER CROSSBARS USING (6) 1/4"-20 x 0.875" LONG CSK SOCKET HEAD SCREWS AND AN ALLEN KEY.

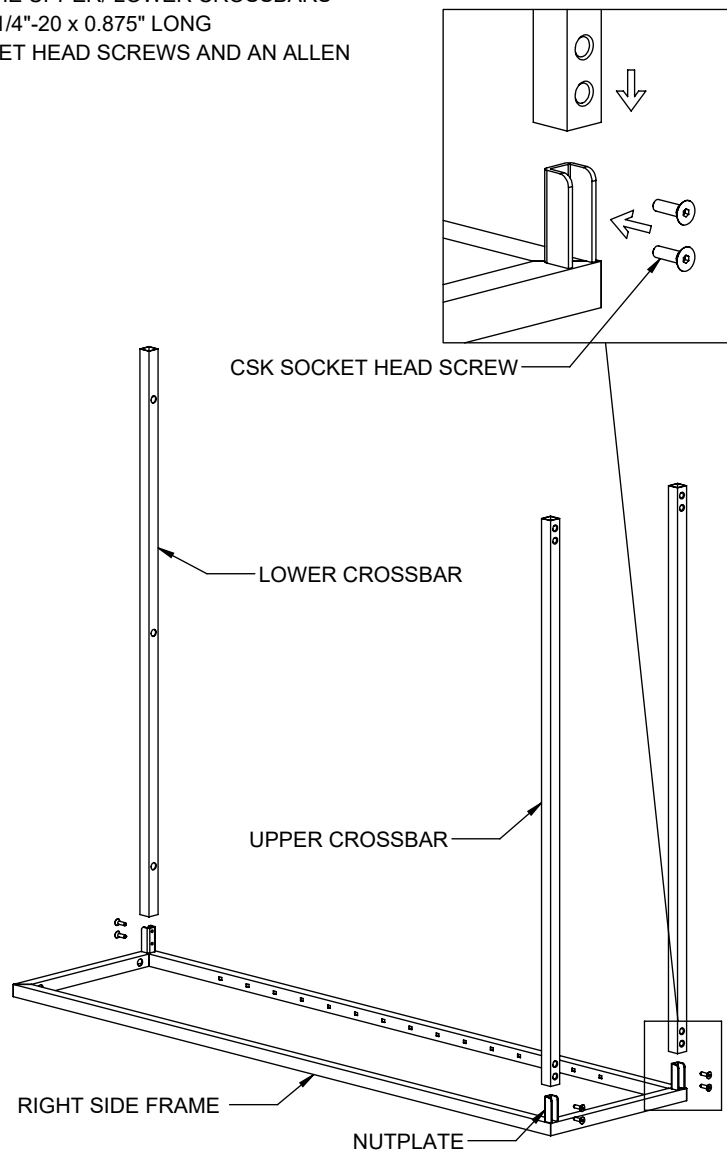

**2**

LOWER THE LEFT SIDE FRAME INTO THE CROSSBARS AND ATTACH USING (6) 1/4"-20 x 0.875" LONG CSK SOCKET HEAD SCREWS AND AN ALLEN KEY.

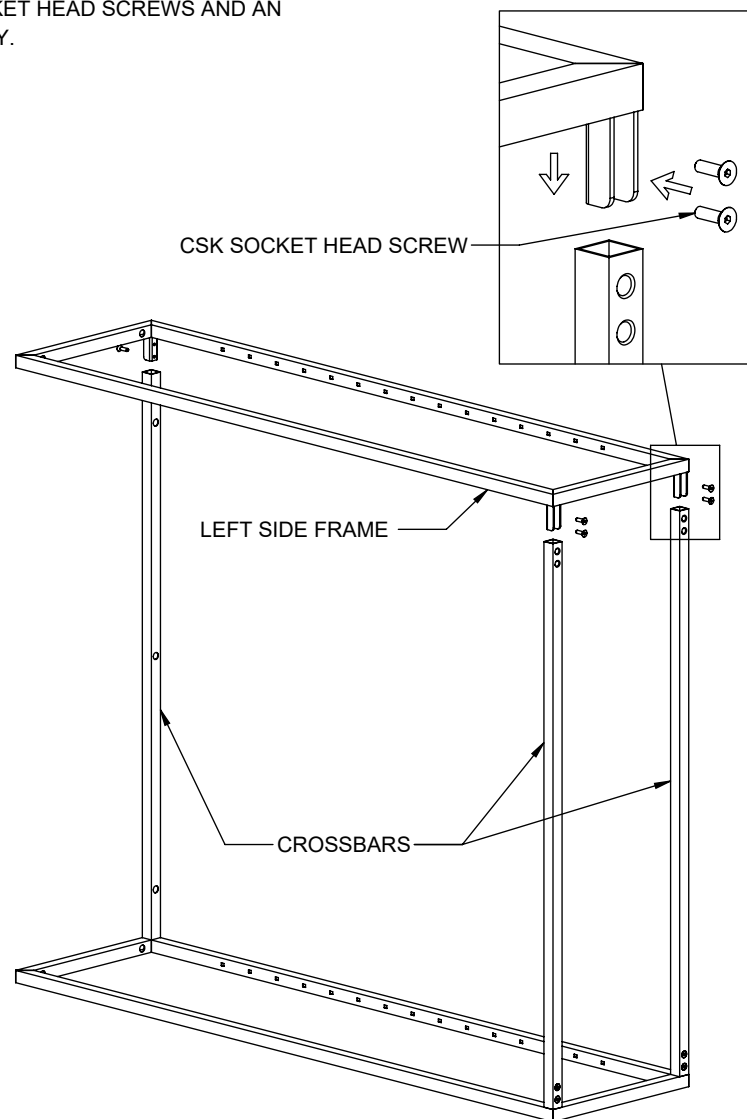

### 3

PLACE THE TOPPER FRAME ON TOP OF THE BACK-WRAP UNIT, AND USE THE CLEARANCE HOLES TO LAYOUT THE PILOT HOLE POSITIONS ON THE TABLE TOP. THEN REMOVE THE TOPPER FRAME AND DRILL (7) 1/8" PILOT HOLES. SEE NEXT PAGE FOR HOLE PATTERN REFERENCE.

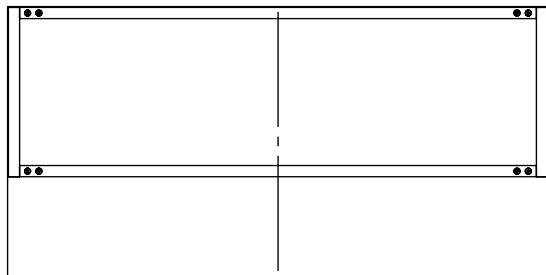

\*MAKE SURE THE TOPPER FRAME IS CENTERED ON THE TABLE TOP\*

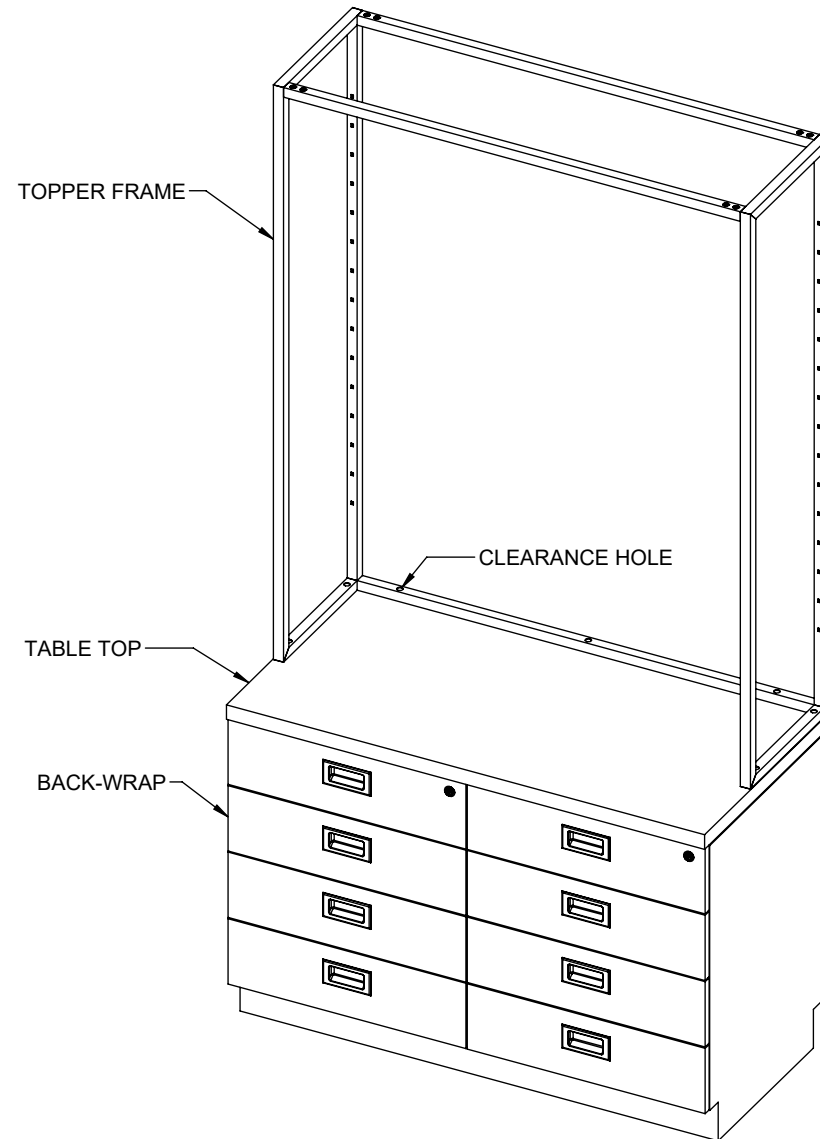

**HOLE PATTERN REFERENCE**

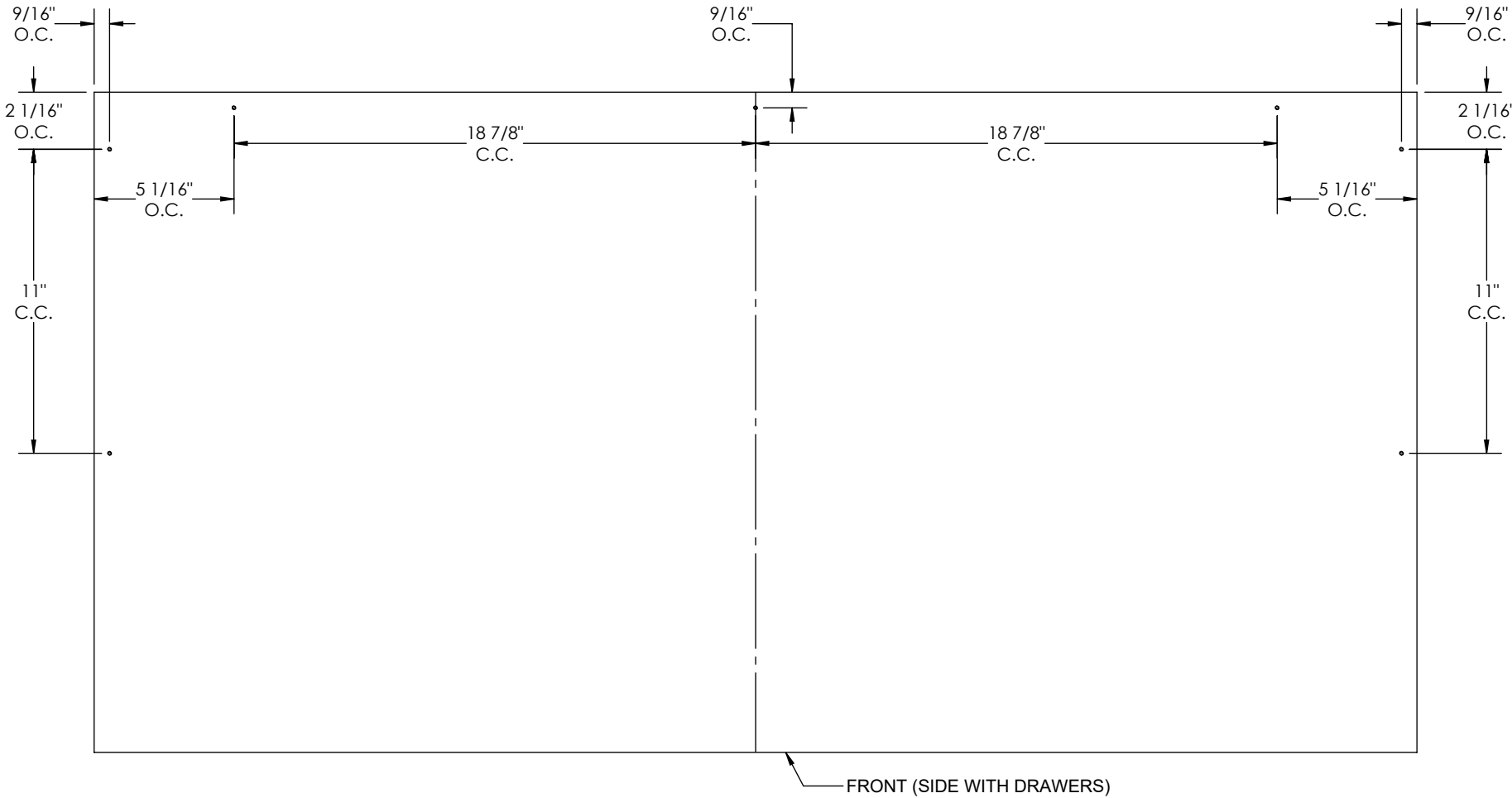

**4**

LOWER THE TOPPER FRAME ONTO THE BACK-WRAP UNIT AND FASTEN USING (7) #10 WOOD SCREWS, THEN COVER THE CLEARANCE HOLES WITH (7) NYLON SNAP-IN PANEL PLUGS.

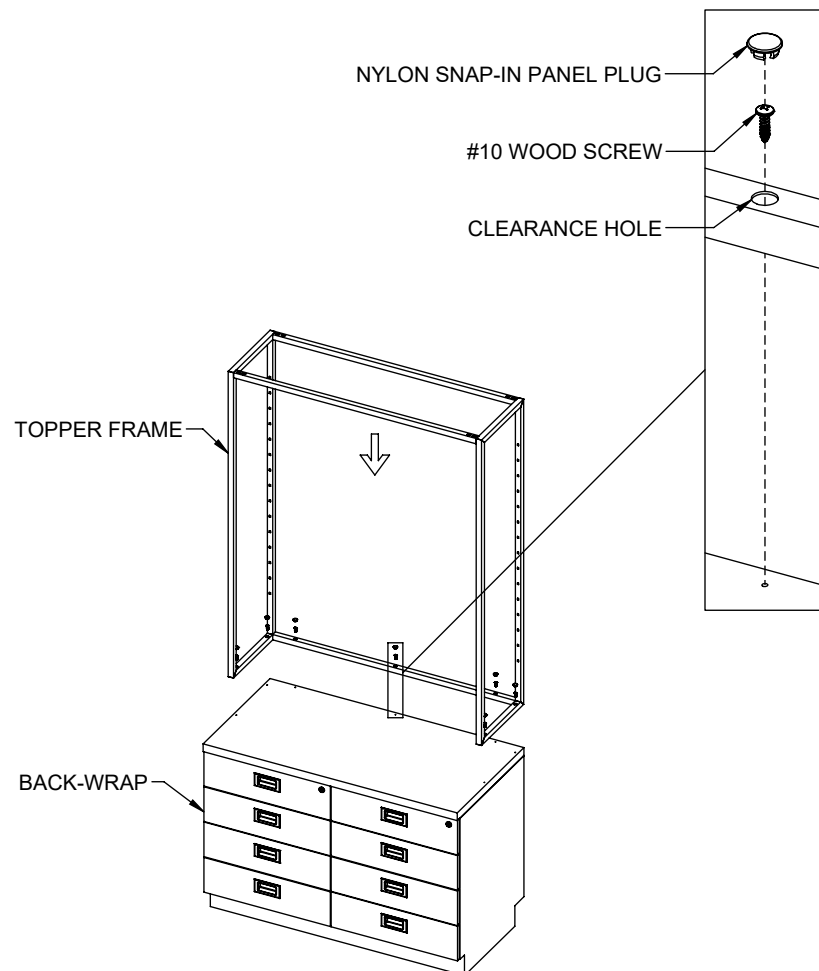
**5**

INSERT (4) SHELF PINS INTO SLOTS ON THE UPRIGHTS AT YOUR DESIRED HEIGHT, THEN LOWER ONE OF THE SHELF FRAMES ONTO THE SHELF PINS.

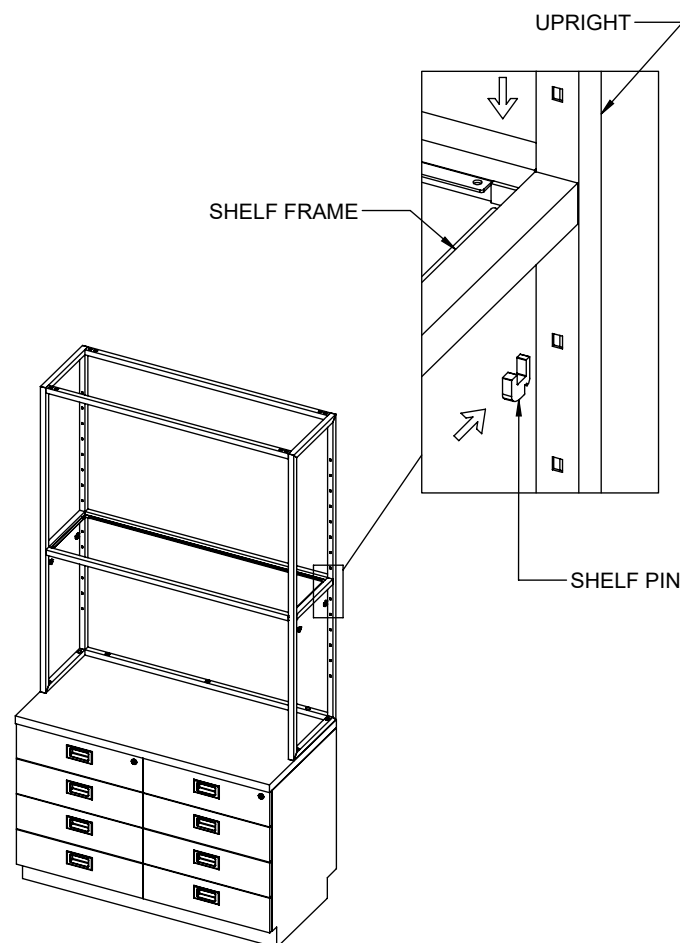

**6**

PRESS (12) RUBBER BUMPERS INTO THE HOLES IN THE SHELF FRAME, THEN LOWER THE GLASS SHELF PANELS INTO PLACE.

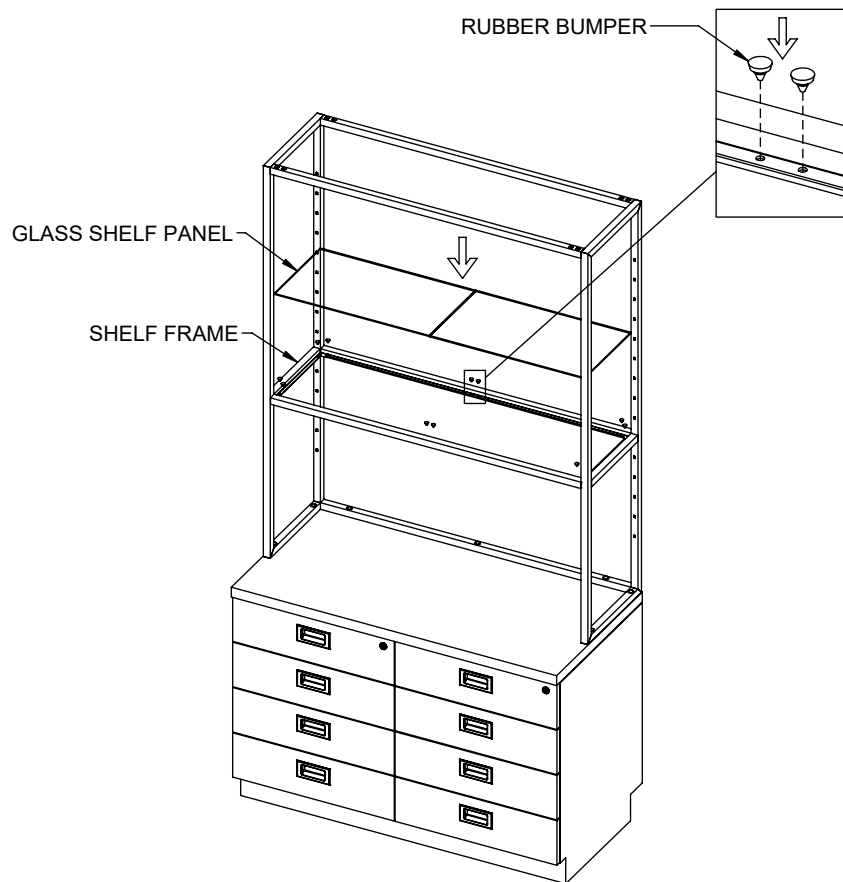

**7**

REPEAT STEPS 5 AND 6 FOR THE REST OF THE SHELVES.

