

FREESTANDING PIPE UNIT 8' HIGH

PSFS96

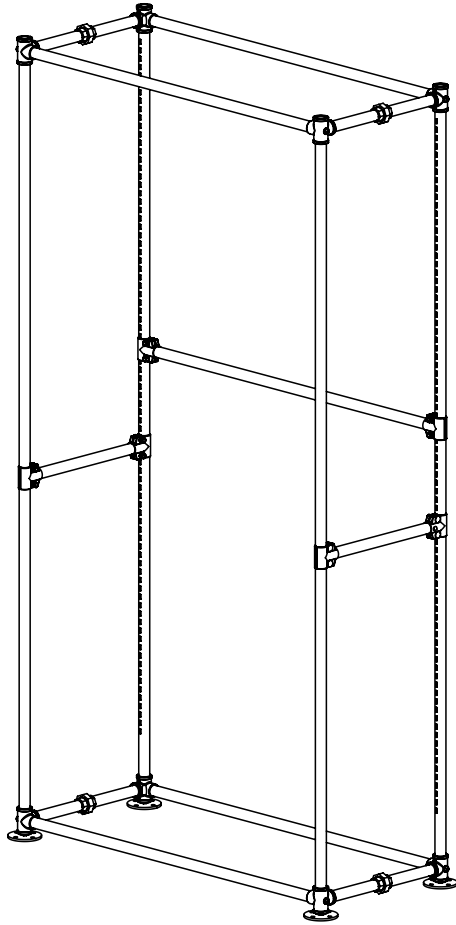

INCLUDED HARDWARE

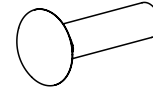

12x
3/8" x 1.5" LONG CARRIAGE BOLT



12x
3/8" SERRATED NUT

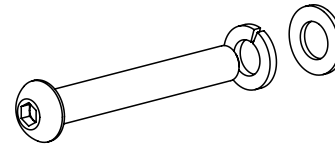

8 SETS
-3/8"-16 x 2.75" LONG HEX HEAD BOLT
-3/8" LOCK WASHER
-3/8" FLAT WASHER

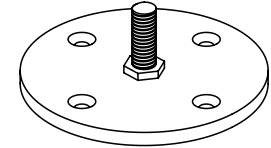

4X
LEVELER

TOOLS REQUIRED



ALLEN KEY

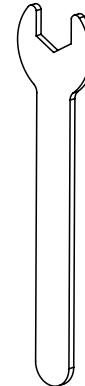

**WRENCH FOR
SERRATED NUTS**

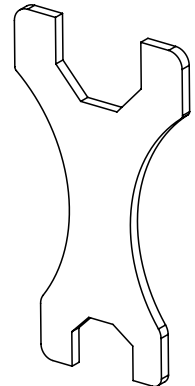

**WRENCH FOR
PIPE UNIONS**

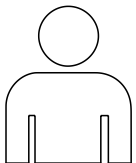

**2 PEOPLE
REQUIRED
FOR
ASSEMBLY**

1

ARRANGE (1) UPRIGHT-1, (1) UPRIGHT-2 AND (2) OF THE CROSS BARS AS SHOWN.

NOTE: BE SURE UPRIGHTS ARE ORIENTATED WITH THE THREADED FITTINGS FOR LEVELERS ON THE BOTTOM AND THREADED OPENINGS ARE FACING UP.

INSTALL THE LEVELERS INTO THE THREADED FITTINGS OF THE UPRIGHTS.

ASSEMBLE THE UPRIGHTS WITH THE CROSS BARS USING BOLTS AND WASHERS AS SHOWN.

TIGHTEN USING THE INCLUDED ALLEN KEY.

2x

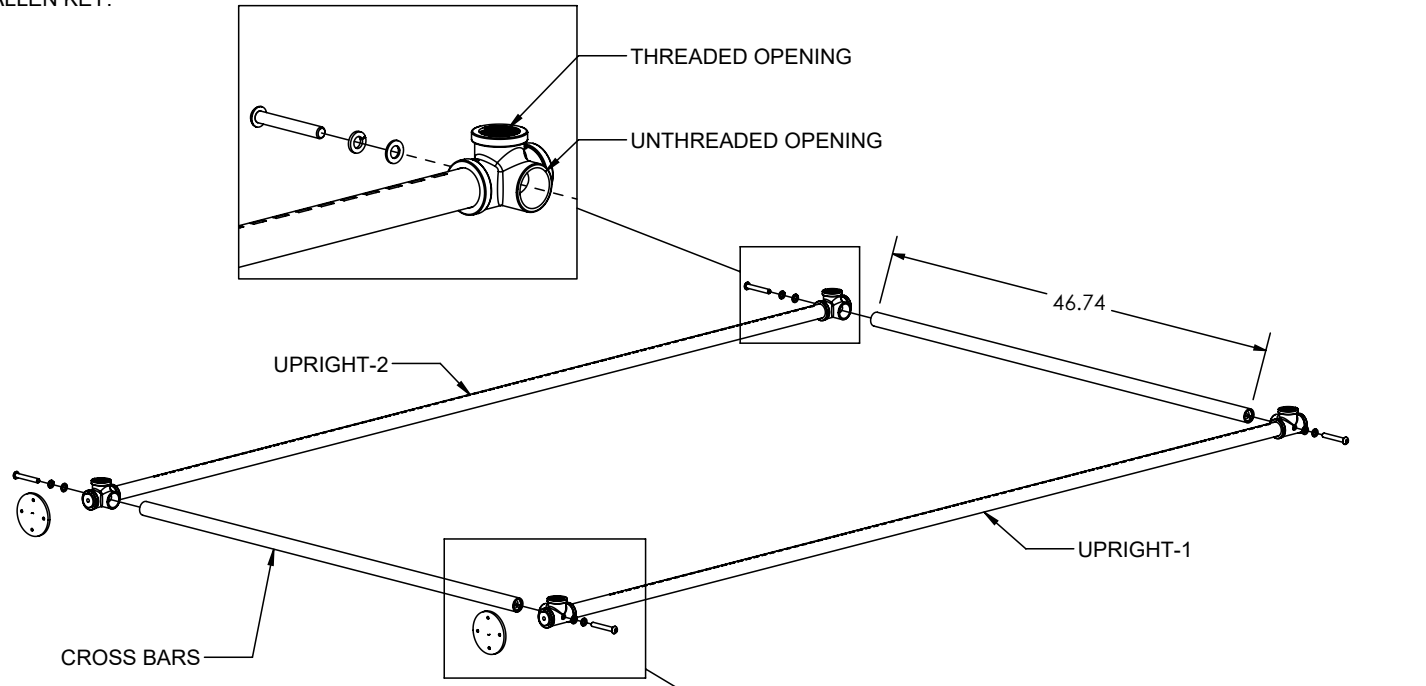

HARDWARE REQUIRED

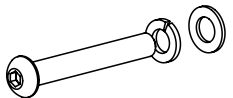

8 SETS
-3/8"-16 x 2.75" LONG HEX HEAD BOLT
-3/8" WASHER
-3/8" LOCK WASHER

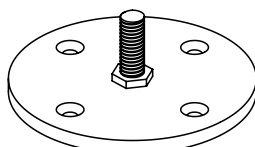

4X
LEVELER

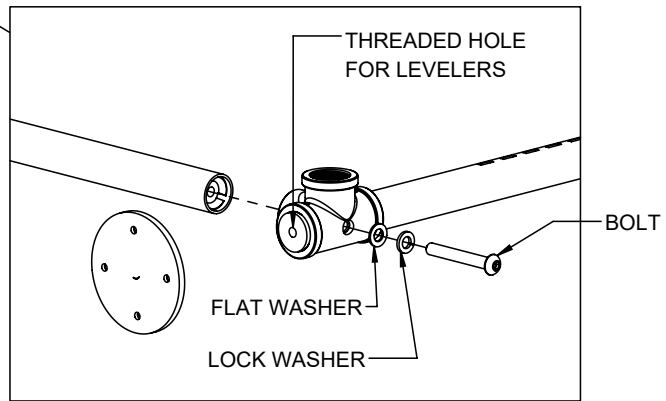

2

INSTALL THE THREADED HALF OF THE UNION CROSS BAR TO ONE OF THE ASSEMBLED FRAMES FROM STEP 1.
USE THE SMALL END OF THE UNION WRENCH TO TIGHTEN.

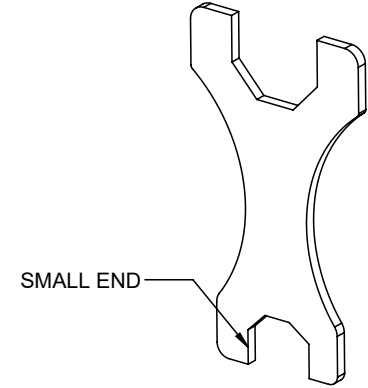
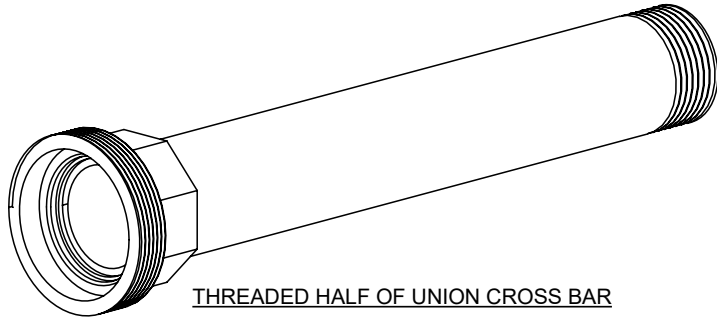

**WRENCH FOR
PIPE UNIONS**

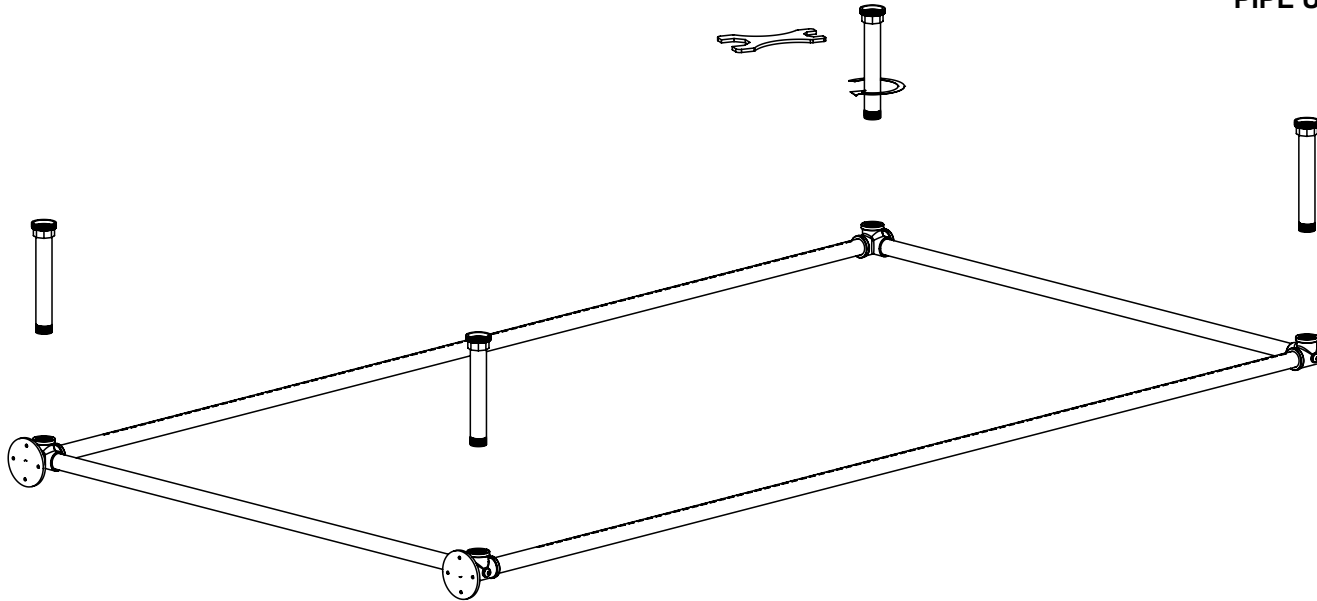

3

SLEEVE THE PIPE UNION NUT AROUND THE UNTHREADED HALF OF THE UNION CROSS BAR AS SHOWN.
INSTALL THE UNTHREADED HALF OF THE UNION CROSS BAR TO THE REMAINING ASSEMBLED FRAME FROM STEP 1.
USE THE SMALL END OF THE UNION WRENCH TO TIGHTEN.

NOTE: THE UNION NUT WILL BE LOOSE AROUND THE PIPE BUT CAPTURED BY THE CROSS BAR.

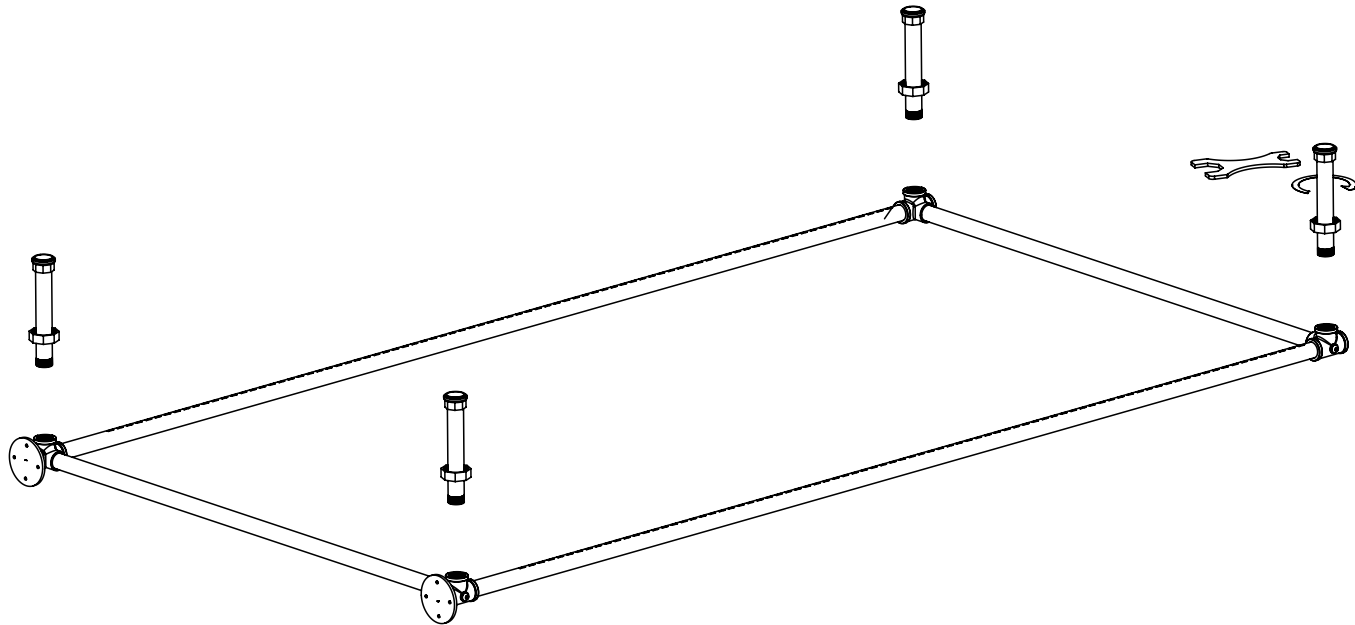
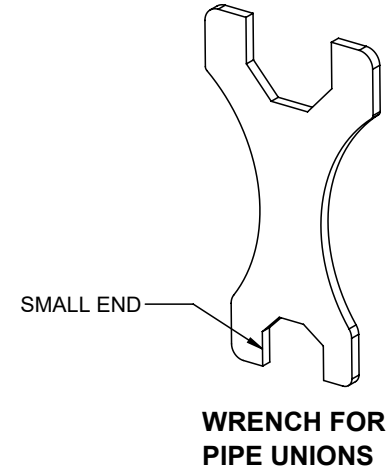
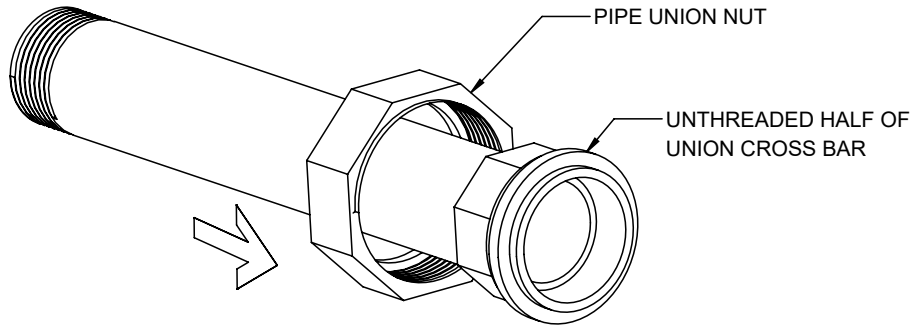

4

WITH AT LEAST 2 PEOPLE, JOIN THE 2 FRAME HALVES. THE HALVES OF THE PIPE UNIONS SHOULD NEST TOGETHER.
NOTE: THE UNTHREADED PIPE UNION SHOULD SEAT INTO THE THREADED PIPE UNION.

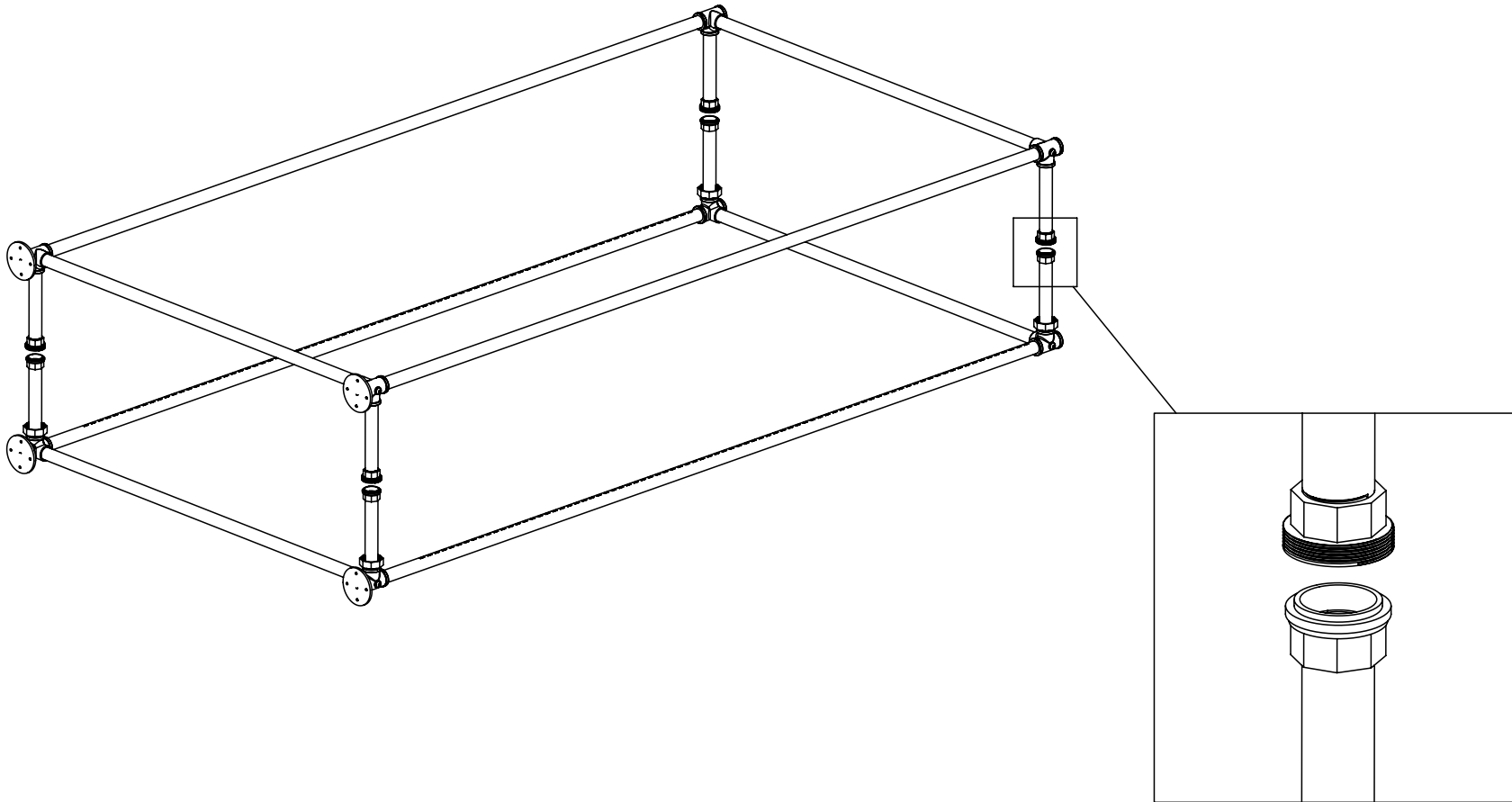

5
SLEEVE THE PIPE UNION NUT AROUND THE THREADED HALF OF THE PIPE UNION CROSS BAR AND TIGHTEN WITH THE LARGE END OF THE UNION WRENCH.

NOTE: ONCE TIGHT, THE THREADING ON THE PIPE UNION SHOULD BE HIDDEN.

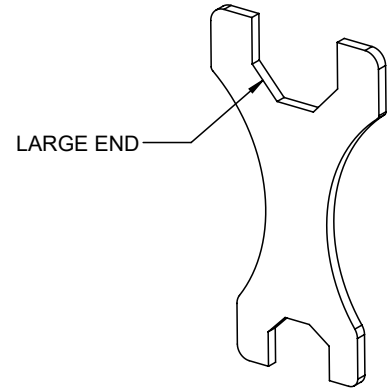
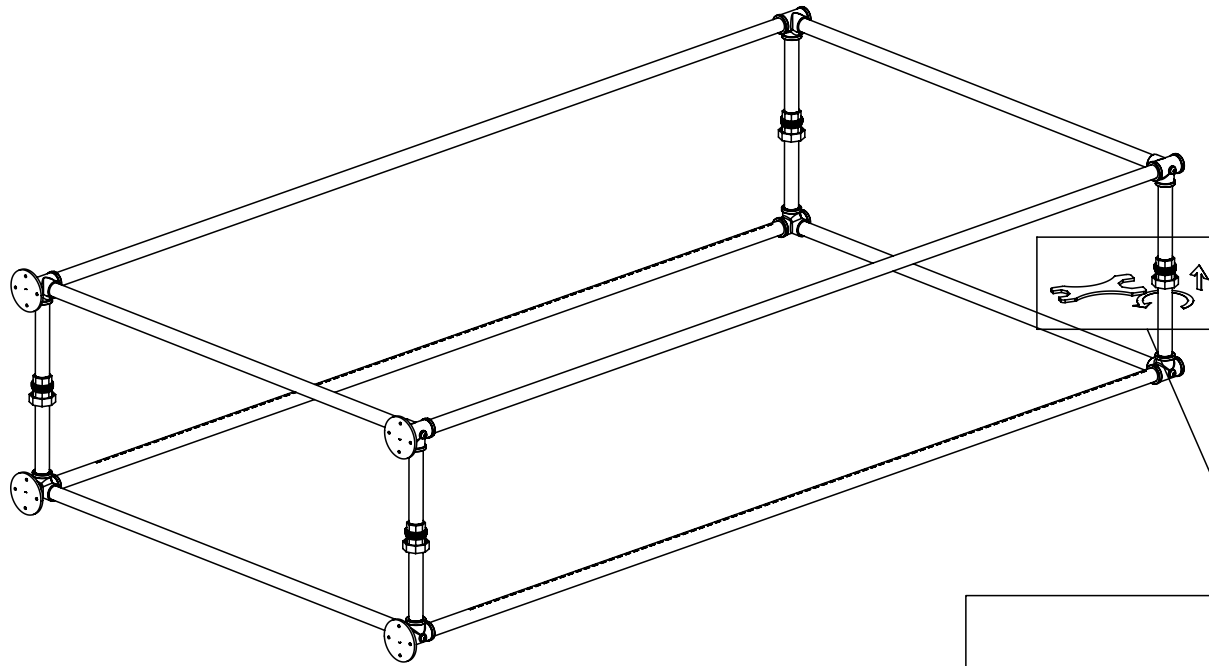

WRENCH FOR PIPE UNIONS

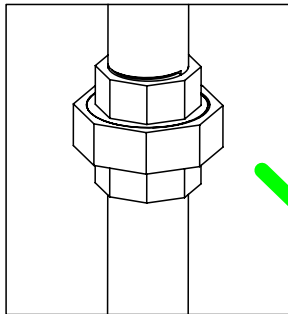

PIPE UNION TIGHT

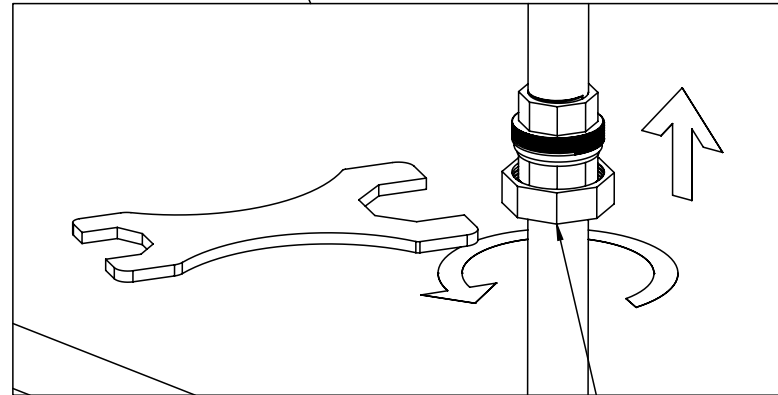

UNION NUT



6

ALL SUPPORT BARS (SHORT AND LONG) CAN BE INSTALLED ANYWHERE THAT WON'T INTERFERE WITH ACCESSORY PLACEMENT.

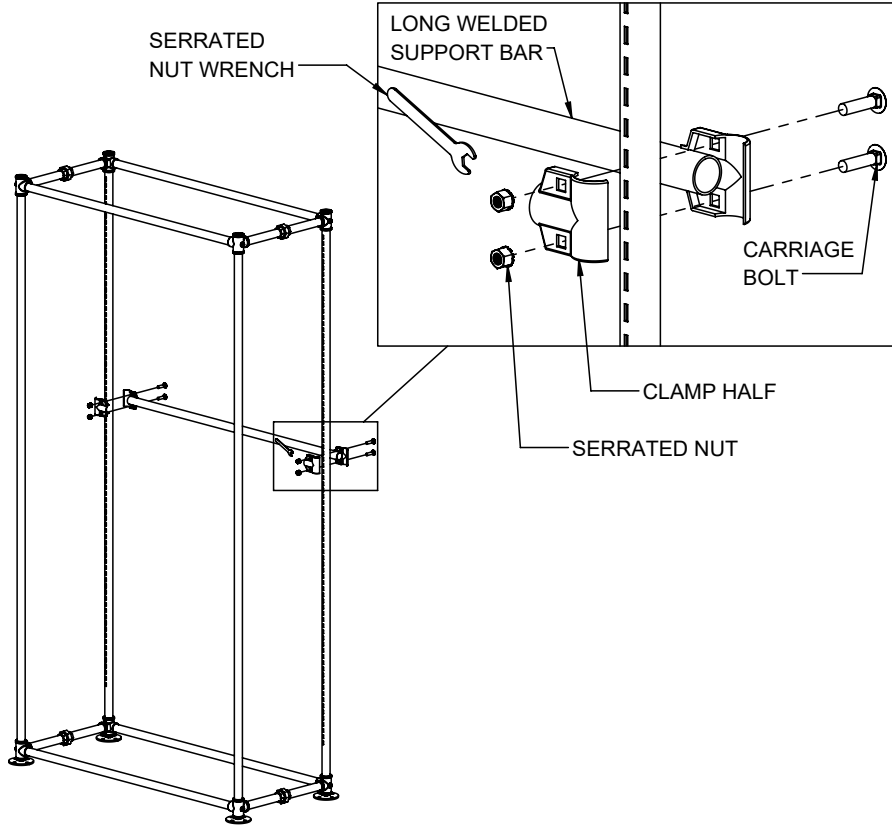
WITH ONE PERSON HOLDING THE LONG WELDED SUPPORT BAR, SECURE THE CLAMP HALVES AS SHOWN. TIGHTEN WITH THE SERRATED NUT WRENCH.

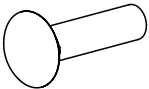

HARDWARE REQUIRED

 <p>4x 3/8" x 1.5" CARRIAGE BOLT</p>	 <p>4x 3/8" SERRATED NUT</p>
--	--

7

REPEAT STEP 6 FOR THE SHORT CROSS BRACES.

